

Thank you to our collaborators!





Margo Gustina

Special Projects Librarian, Rural Library Service and Social Wellbeing, Southern Tier Library System (NY), 2018 Library Journal Mover & Shaker



Eli Guinnee

State Librarian, New Mexico State Library



PRIVACY, CONFIDENTIALITY, AND INTELLECTUAL FREEDOM IN THE LIBRARY

Margo Gustina

Southern Tier Library System

gustinam@stls.org



STLS

Southern Tier Library System

Connecting Community Libraries

Eli Guinnee

New Mexico State Library

eli.guinnee@state.nm.us



HOORAY 4 FREEDOM

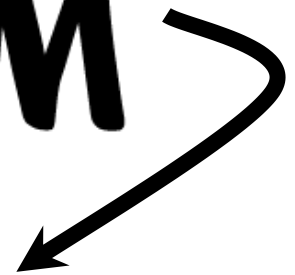

PRIVACY, CONFIDENTIALITY

DOM IN THE LIBRARY

Policy
Edition

Margo Gustina

Southern Tier Library System
gustinam@stls.org

Eli Guinnee

New Mexico State Library
eli.guinnee@state.nm.us



STLS

Southern Tier Library System

Connecting Community Libraries



Homework

Does your state, local government or library system have specific allowances or protections for library patron records?

How did you find this information?

Levels of Interpretation

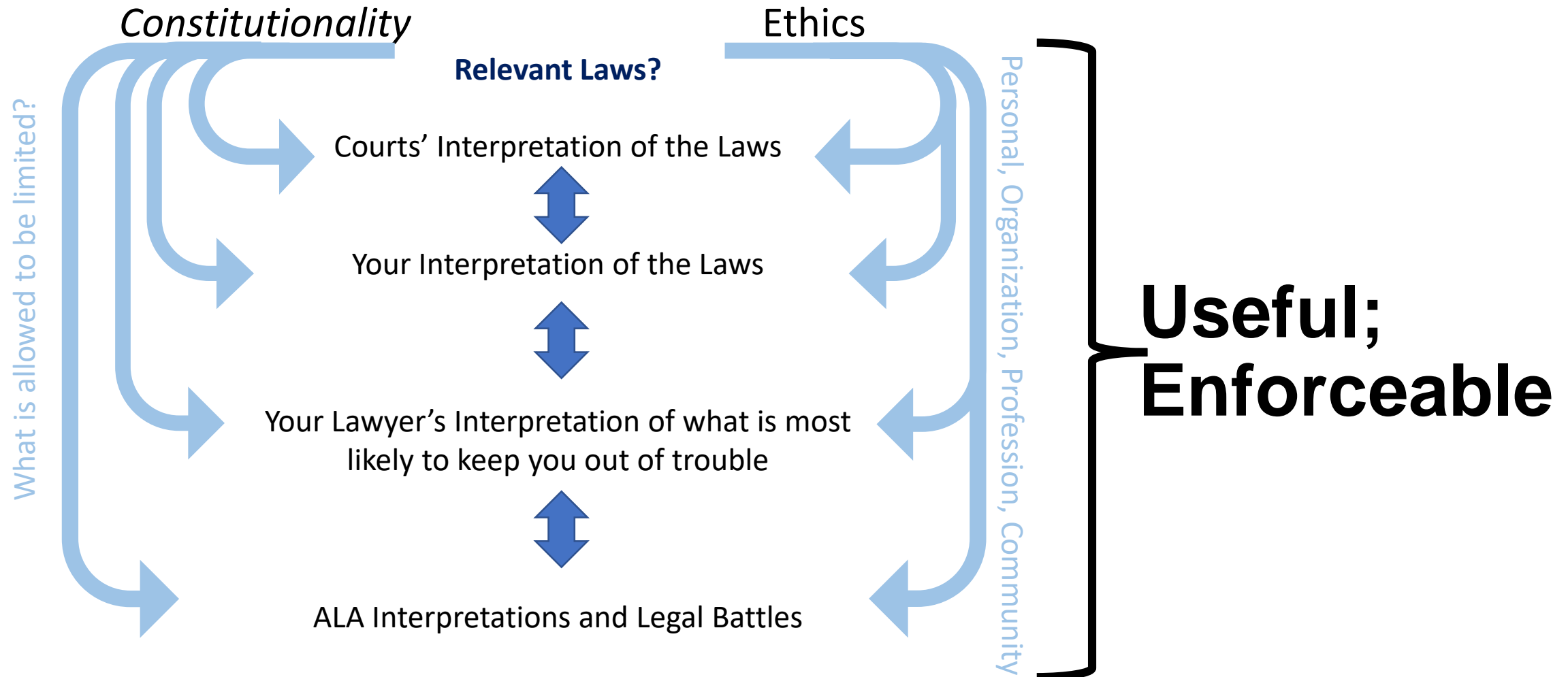

Suggested Policies to Support Intellectual Freedom

- ☒ Circulation of and Challenge to Library Materials
- ☒ Confidentiality of Patron Records
- ☒ Meeting Room / Bulletin Board / Display Case
- ☒ Rights of Minors
- ☒ Internet / Wireless Use
- ☒ Patron Behavior

Guiding Principles:

Fit your **mission**.

Broaden access to protected speech.

Limitations must be unavoidable, **objective**,
and **evenly applied** across content areas.

Method of **appeal**.

Mission Statement

Providence Public Library inspires lifelong education among all Rhode Islanders, fostering personal fulfillment and enhanced quality of life for an informed, enlightened and engaged citizenry.

Annotation Tools

1. Mouse over slide to find **small pill menu** at far **left**
2. Select top **squiggle icon** to open annotation tool panel
3. Select **square** icon
4. Select **check mark**
5. Click on slide **to practice**

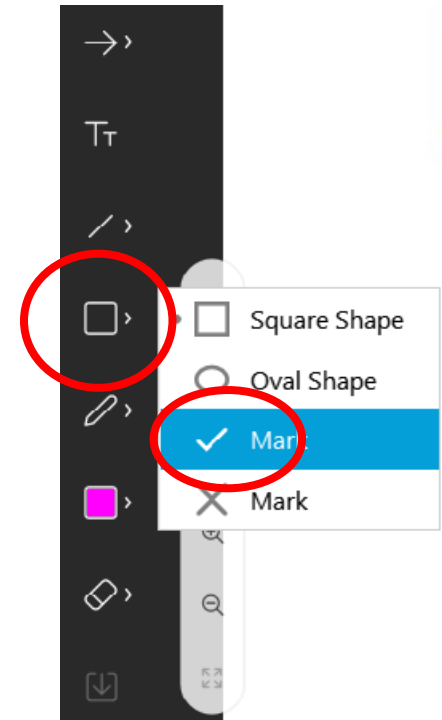

**Does this
 policy
 satisfy the
 guiding
 principles?**

YES ✓	Fits the mission ✓	NO ✓
YES	Broadens access ✓	NO ✓
YES ✓	Unavoidable / Objective ✓	NO
YES ✓	Method of appeal ✓	NO ✓

Privacy of Patron Records:

“...such [patron data] records shall not be made available to an agency of state, federal, or local government except pursuant to such process, order, or subpoena...”

YES	Fits the mission	NO
YES	Broadens access	NO
YES	Unavoidable / Objective	NO
YES	Method of appeal	NO

Privacy of Patron Records:

Ensure that your public library's goals and objectives support households across the area you serve. By integrating powerful demographics, *Gale Analytics* adds value to existing data—including content from your library's ILS and other electronic systems—unlocking key insights about your community. Customized reports better equip your library and staff to target new populations, create new programs, market library services, and allocate resources more efficiently.

Gale Analytics uses the power of Experian's Mosaic® USA proprietary household segmentation system to make it easier for you to understand your community.

Gale Analytics

Wireless Access

Bethlehem Public Library is dedicated to providing the community with the most current information available. Public access to the Internet is an extension of the library's mission to provide equal and uncensored access to resources in a wide range of formats. The library provides public Internet access through library computers, as well as through dataports and wireless access points for patrons with their own Internet-ready devices.

Patrons use the Internet at their own discretion.

YES	Fits the mission	NO
YES	Broadens access	NO
YES	Unavoidable / Objective	NO
YES	Method of appeal	NO

Wireless Access

The library turns off the wireless router when the library closes at the end of the day.

Internet Access

Because of the limited number of public access computers, the library reserves the right to enforce rules to provide equitable Internet access for all patrons. See the librarian for current rules of use for public access computers and wireless access.

YES	Fits the mission	NO
YES	Broadens access	NO
YES	Unavoidable / Objective	NO
YES	Method of appeal	NO

Internet Access

In order to use internet enabled public access computers at the library, you must be a library card holder. AKA – members only service policy.

Internet Access

Is all speech protected by the 1st Amendment?

Sexually obscene (any reasonable without prurient interest person would see it as obscene without artistic or cultural merit);

Illegal (e.g. naked images of children);

Hate speech/incite to riot and/or violence

Meeting Room (bulletin board / display cases)

Meeting & Study rooms may be reserved by:

Non-profit, educational, government, or community organizations and businesses conducting training or peer-to-peer networking may use the rooms free of charge.

Groups using the meeting rooms for social events, showers, birthdays, direct sales parties, etc., will be charged a room use fee, payable in advance. (See fee schedule.)

Study Rooms may not be used for social events.

Business outside of the library's taxing district will be charged a room use fee of \$100, payable in advance

YES	Fits the mission	NO
YES	Broadens access	NO
YES	Unavoidable / Objective	NO
YES	Method of appeal	NO

Meeting Room

Dig in deeper:

Intellectual Freedom Manual

ALA Webinars

Deliberative Democracy Practice

Collection & Challenges

Scope of Collection

The Library extensively acquires and provides access to scholarly materials in subject areas offered in the academic programs at FGCU. Both undergraduate and graduate level study materials are collected as well as materials supporting the research and scholarship needs of faculty.

YES	Fits the mission	NO
YES	Broadens access	NO
YES	Unavoidable / Objective	NO
YES	Method of appeal	NO

Collection & Challenges

**BECAUSE
LIBRARIANS
STAND UP FOR
YOUR RIGHT
TO READ**

**LIBRARIES
TRANSFORM[®]
INDIANA**

Sometimes the
patron is right.

Is that censorship?

Circulation

If the patron does not have the required address verification item, a limit of two items may be checked out or materials may be held for 24 hours at the library. The library may send a postcard to the patron's current street address that maybe returned to the library and used for address verification.

YES	Fits the mission	NO
YES	Broadens access	NO
YES	Unavoidable / Objective	NO
YES	Method of appeal	NO

Circulation

What is constitutionally problematic about circulation periods based on age rather than item type (or both)?

Patron Behavior

The library is not an appropriate place to leave children and dependent adults with obvious medical conditions that require close monitoring.

YES	Fits the mission	NO
YES	Broadens access	NO
YES	Unavoidable / Objective	NO
YES	Method of appeal	NO

Patron Behavior

Parents may not instruct children to use the library as shelter because of their unwillingness or inability to pay for appropriate care for them.

YES	Fits the mission	NO
YES	Broadens access	NO
YES	Unavoidable / Objective	NO
YES	Method of appeal	NO

Patron Behavior

What is your motivation for restricting a specific behavior?

Does the way in which you enforce that restriction support your motivation and remain consistent with your mission?

Questions?

HOORAY 4 CONTACTS!

Margo Gustina

STLS

gustinam@stls.org

Eli Guinnee

NM State Library

eli.guinnee@state.nm.us

